

HM Land Registry CERTIFICATE OF RESULT OF OFFICIAL SEARCH OF THE INDEX MAP (Form 96 Result)

<b>Property</b>	
Postal number or description	<i>Land at Houghton Moor</i>
Name of road	
Name of locality	<i>Houghton Moor</i>
Town	<i>Hendon on the Wall</i>
Postcode	
District or London Borough	<i>Cstle Morpeth</i>
Administrative County	<i>Northumberland</i>
Ordnance Map Reference	<i>N21066-2165</i> (Note 3)
Known Title Number(s)	
<b>Enter Name and Address</b> (to which the official certificate of result of search is to be sent.)	
<i>McCarthy &amp; Tilson</i> <i>184 Chillingham Road</i> <i>Heaton</i> <i>Newcastle upon Tyne</i> <i>NE6 5BU</i>	
Reference	<i>MH/JW/D310</i>

It is certified that the official search applied for has been made with the following result:- (Only the statements opposite the boxes marked X apply.)

- The land \_\_\_\_\_ is not registered. (Note 5)
- The land \_\_\_\_\_ is not affected by any caution against first registration or any priority notice.
- The land \_\_\_\_\_ is affected by a pending application for first registration under the following reference \_\_\_\_\_
- The land \_\_\_\_\_ is registered freehold under Title No. \_\_\_\_\_
- The land \_\_\_\_\_ is registered leasehold under Title No. \_\_\_\_\_
- The land \_\_\_\_\_ is affected by a rentcharge under Title No. \_\_\_\_\_
- The land \_\_\_\_\_ is affected by a caution against first registration/ priority notice under Title No. \_\_\_\_\_



Please enclose this result of search and any plan annexed thereto with any correspondence or application for first registration relating to the above property.

## EXPLANATORY NOTES

1. "Parcel of land" means all or any part of:

(a) a dwelling \*; or

(b) any other land which is separately occupied or if not separately occupied, in separate ownership; and for this purpose an owner is the person who (in his own right or as trustee for any other person) is entitled to receive the rack rent of land, or, where the land is not let at a rack rent, would be so entitled if it were so let.

\* "dwelling" means a building or part of a building occupied or intended to be occupied as a separate dwelling, together with any yard, garden, outhouse and garage belonging to it.

2. Please send this application to the appropriate District Land Registry. This information is contained in Explanatory Leaflet No. 9 obtainable free of charge from any district land registry.

3. Please provide the Ordnance Map Reference if known. Where this is not supplied by you it will be entered by the Land Registry. This reference should be quoted on any subsequent application for first registration.

4. Please ensure that the appropriate fee payable under the current Land Registration Fee Order accompanies your application.

Where you have requested that the fee be paid by Credit Account, receipt of this certificate of result is confirmation that the appropriate fee has been debited.

5. On and after the 1 December 1990 all of England and Wales will be subject to compulsory registration. Until that date the districts set out below are not subject to compulsory registration.

DISTRICT	COUNTY	DISTRICT LAND REGISTRY OFFICE
LEOMINSTER MALVERN HILLS SOUTH HEREFORDSHIRE WYCHAVON WYRE FOREST	HEREFORD AND WORCESTER	SWANSEA
CASTLE POINT MALDON ROCHFORD TENDRING	ESSEX	PETERBOROUGH
BABERGH FOREST HEATH MID SUFFOLK ST EDMUNDSBURY SUFFOLK COASTAL	SUFFOLK	KINGSTON UPON HULL

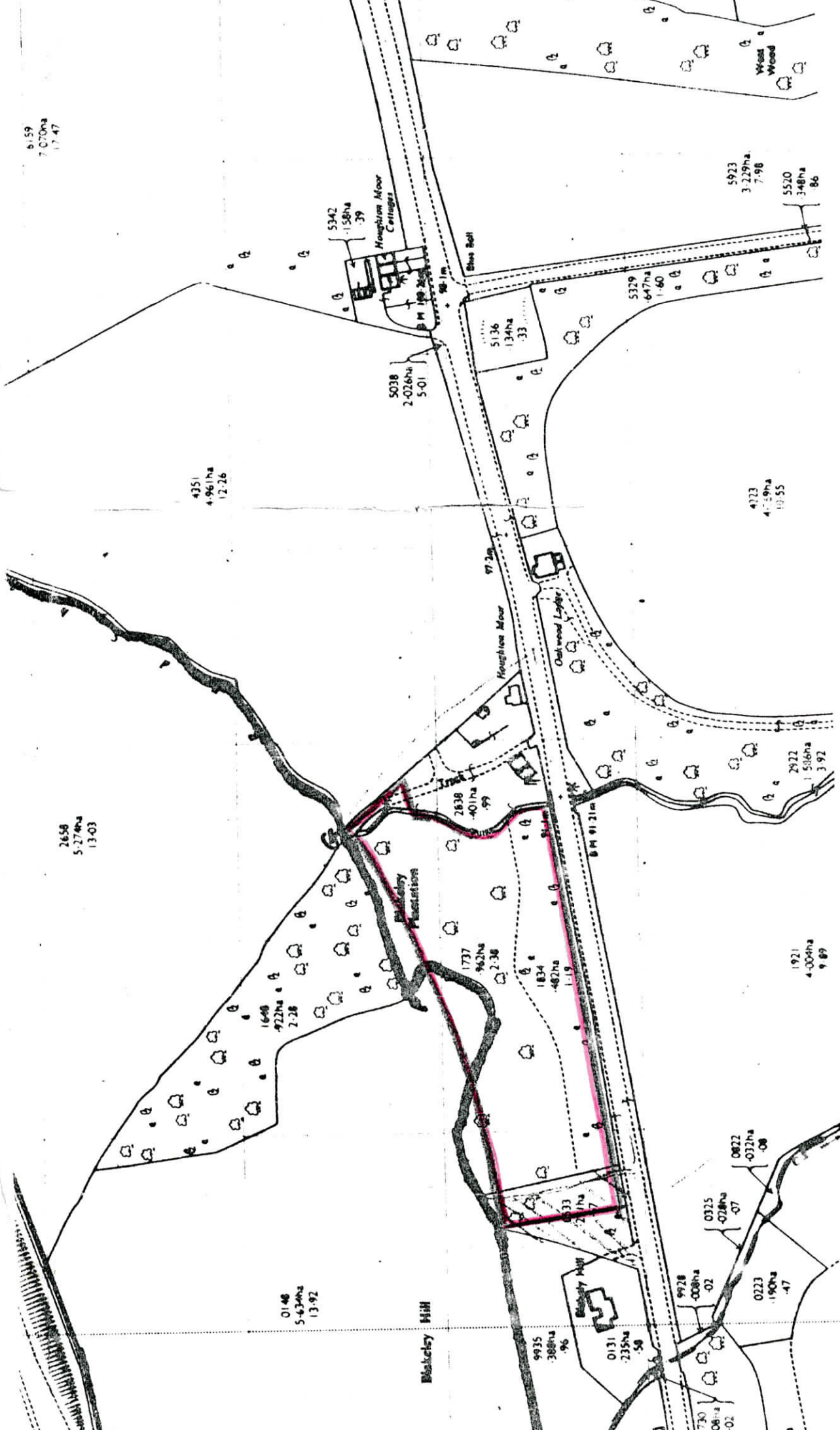

6.159  
7.070ha  
17.47

5923  
3.229ha  
7.98  
5520  
3.48ha  
86

5342  
1.58ha  
39  
Moughlin Moor  
Cottages

5038  
2.026ha  
5.01

5136  
1.34ha  
33

5329  
6.47ha  
1.60

4351  
4.961ha  
12.26

4773  
4.229ha  
10.55

2658  
5.274ha  
13.03

2838  
4.01ha  
99

2822  
1.506ha  
3.92

1737  
1.92ha  
2.38

1834  
1.19ha

1921  
4.004ha  
9.89

0146  
5.434ha  
13.92

Blackley Mill

0131  
2.35ha  
58  
Blackley Mill

9935  
3.68ha  
96

9730  
0.08ha  
02

9928  
0.08ha  
02

0223  
1.90ha  
47

0225  
0.28ha  
07

0822  
0.32ha  
08